

T Panel mounting switch

1P to 12P

Size 2
A 50|63|80|100|125|175



Technical information

According to IEC/EN 60947-3
UL508 - CAN/CSA C22.2 N° 14

According to IEC 60947-3			T50	T63	T80	T100	T125	T175	
Rated thermal current	Ith	A	63	80	80	125	125	200	
Rated insulation voltage	Ui	V	690	690	690	690	690	1000	
Rated impulse withstand voltage	Uimp	kV	8	8	8	8	8	8	
AC rated operational current	Ie	Ue 415V AC21A	A	63	80	80	125	125	200
		Ue 415V AC22A	A	63	80	80	115	115	200
		Ue 690V AC21A	A	63	80	80	115	115	175
		Ue 690V AC22A	A	63	63	63	100	100	160
		3x240V AC23A	kW	18,5	22	22	30	30	55
		3x240V AC3	kW	15	18,5	18,5	30	30	37
AC rated operational power (Rated operational frequency 50/60 Hz)	Pe	3x240V AC4	kW	5,5	7,5	7,5	11	11	15
		1x240V AC3	kW	7,5	11	11	15	15	18,5
		1x240V AC4	kW	3	3	3	4	4	5,5
		3x415V AC23A	kW	30	37	37	45	45	90
		3x415V AC3	kW	22	30	30	37	37	75
		3x415V AC4	kW	11	11	11	15	15	18,5
		1x400V AC3	kW	15	18,5	18,5	18,5	18,5	20
		1x400V AC4	kW	4	5,5	5,5	7,5	7,5	11
		3x500V AC23A	kW	30	37	37	55	55	110
		3x500V AC3	kW	22	30	30	45	45	75
		3x500V AC4	kW	11	11	11	15	15	18,5
		3x690V AC23A	kW	37	45	45	55	55	75
3x690V AC3	kW	37	45	45	45	45	55		
3x690V AC4	kW	11	11	11	15	15	18,5		
Rated conditional short-circuit current		kA	15	15	15	15	15	15 ⁽²⁾	
Rated maximum current	gL-gG	A	80	80	80	125	125	160	
Rated breaking capacity	400V; cos φ=0,45	A	504	504	504	640	640	1600	
Rated short-time withstand current (1 sec)		A	1600	1600	1600	2500	2500	3500	
Mechanical durability (thousand of operations)			1000	1000	1000	1000	1000	1000	
Rigid copper conductor		mm ²	16/25 ⁽¹⁾	16/25 ⁽¹⁾	16/25 ⁽¹⁾	35/50 ⁽¹⁾	35/50 ⁽¹⁾	95	
Flexible copper conductor		mm ²	10/16 ⁽¹⁾	10/16 ⁽¹⁾	10/16 ⁽¹⁾	16/35 ⁽¹⁾	16/35 ⁽¹⁾	95	
According to UL508 - CAN / CSA C22.2 N° 14			T50	T63	T80	T100	T125	T175	
Rated thermal current	Ith	A	63	63	63	100	100		
General use rating		Vac	600	600	600	600	600		
AC rated operational power	3x240V	HP	20	20	20	30	30	Certification in progress	
	3x480V	HP	40	40	40	50	50		
	3x600V	HP	40	40	40	50	50		

*⁽¹⁾ With terminals for connection

*⁽²⁾ Mounting without connection terminals or terminals + phase barriers DT-90025

Normal service conditions:

Ambient air temperature (°C): -5°...+40°. Maximum altitude: 2.000 m. Maximum humidity: 90%. Pollution degree: 3 (standard for industrial applications). Rated frequency at AC utilization categories: 50/60 Hz.

Rated duties at utilization categories AC21A, AC22A and AC23A: Continuing (8 hours); uninterrupted.

Rated duties at utilization categories AC3 and AC4: Intermittent; temporary.



Series | Amp

- T-00050
- T-00063
- T-00080
- T-00100
- T-00125
- T-00175

Diagram

Posit.	0	1	Chambers
1	X	00010	1
2	X	00011	1
3	X	00012	2
4	X	00013	2
5	X	01075	3
6	X	01076	3
7	X	01077	4
8	X	01078	4
9	X	01079	5
10	X	01010	5
11	X	01011	6
12	X	01012	6

Type

Model or fixing

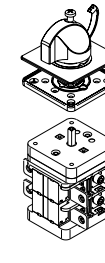

E

Plate and handle

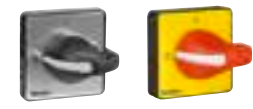

Arrow handle



Padlockable handle

Dimensions (mm)

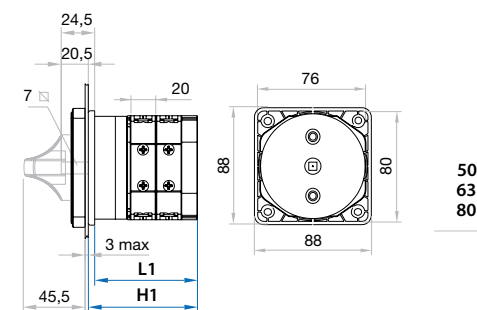
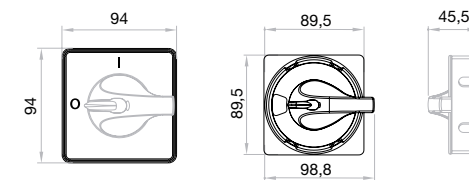

Frontal fixing with 2 screws

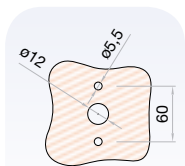

Frontal fixing with 4 screws

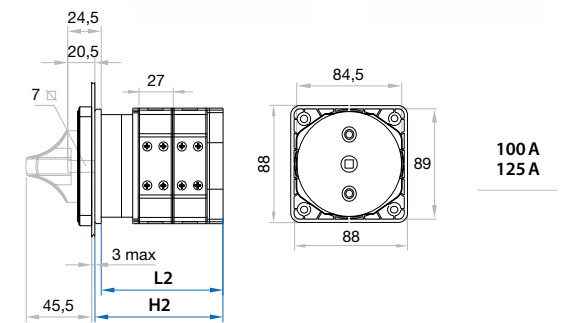
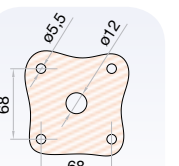

T series	Chambers	1	2	3	4	5	6
T100	L2	67	94	121	148	175	202
T125	H2	71	98	125	152	179	206

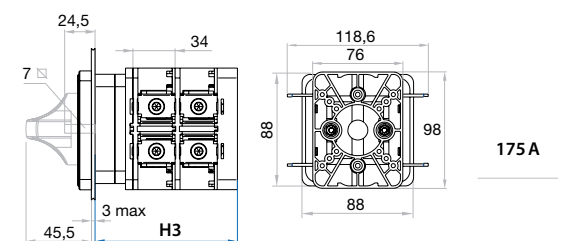

T series	Chambers	1	2	3	4	5	6
T175	H3	80,8	114,8	148,8	182,8	216,8	250,8

T series	Chambers	1	2	3	4	5	6
T50	L1	58,5	78,5	98,5	118,5	138,5	158,5
T63	H1	62,5	82,5	102,5	122,5	142,5	162,5
T80							

>> More accessories of these series, see page xx