

S5000B

Bypass changeover switch base mounting 3P - 3P+N

Size 3

A 800 | 1000

CODE-800A **CODE-1000A**

3P	S5B08003PRO	S5B10003PCO
3P + N	S5B08003NR0	S5B10003NC0

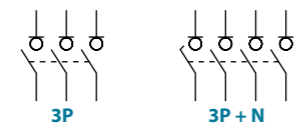
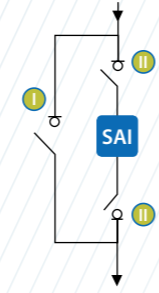

Technical information



According to IEC/EN 60947-3

			800	1000
Rated thermal current	I _{th} in ambient at 40° C 60% HR	A	800	1000
Rated insulation voltage	U _i	V	1000	1000
Rated dielectric strength	50 Hz., 1 min.	V	8000	8000
Rated impulse withstand voltage	U _{imp}	kV	12	12
AC Rated operational current ^{*(1)} (Rated operational frequency 50/60 Hz)	400V AC21A	A	800	1000
	400V AC22A	A	800	1000
	500V AC21A	A	800	1000
	500V AC22A	A	800	1000
	690V AC21A	A	800	1000
AC Rated operational power ^{*(2)}	3x400V AC23A	kW	443,4	501
	3x500V AC23A	kW	554,2	501
	3x690V AC23A	kW	239	544

			800	1000
Rated capacitor power	400V, sen φ=0,65	kVAr	360,2	450,3
Rated breaking capacity	400V AC22A	A	2400	3000
Rated making capacity	400V AC22A	A	2400	3000
Short - circuit behaviour				
Short - circuit making capacity ^{*(2)}	I _{cm}	kA (peak)	60	60
Short - time withstand current (1 sec.)	I _{cw}	kA rms	25	25
Minimum number of mechanical operations ^{*(4)}		Cycles	10000	10000
Minimum number of electrical operations	400V AC22A	Cycles	500	500
Maximum weight (3/4 poles)		Kg	26,5/28,6	26,5/28,6

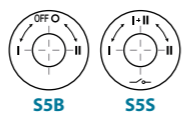

Overlapped contacts (S5S series), under request.

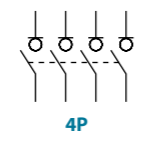

Also available 4P changeover switches under request, consult reference

^{*(1)} Other voltages and/or utilization categories; please consult us
^{*(2)} Indicative values, value cos φ=0,8
^{*(3)} Without limiting protective device (short - circuit maintained 50 ms. - 200 ms.)
^{*(4)} Please consult us for more operations

Accessories



Direct handle
CODE D5LLI32



Panel handle included shaft ^{*(e1)}
IP65|UL50E/NEMA 250
Types: 1, 3R, 4, 4X y 12
CODE D5LLA31

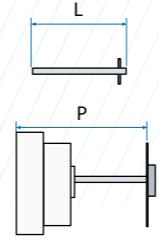

Shafts
Standard shaft included ^{*(e1)}
L (mm) | P (mm)
239 | 480... 645



Auxiliary contacts
1NA+1NC CODE DS-AU11
2NA+2NC CODE DS-AU12
I_e = 16 A (resistive loads)
4 A (inductive loads) at 250 Vac.



Terminal shrouds
CODE DS-CU31
(1 kit for input or output only front side)



Safety key lock device
Simple CODE D5LCB31
Double CODE D5LCF31
For external handle, lock the handle by means of a key in position "OFF" (under request, in "ON"), the key can only be removed with the handle locked

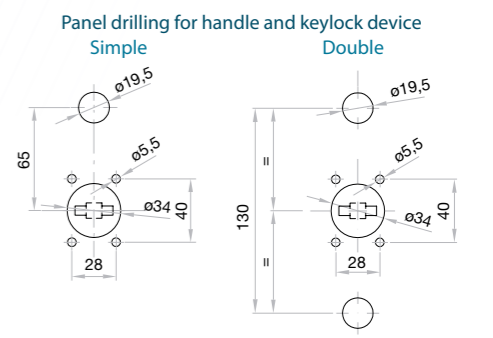

Dimensions (mm)

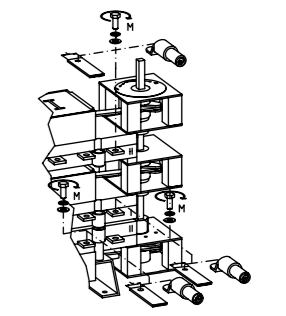
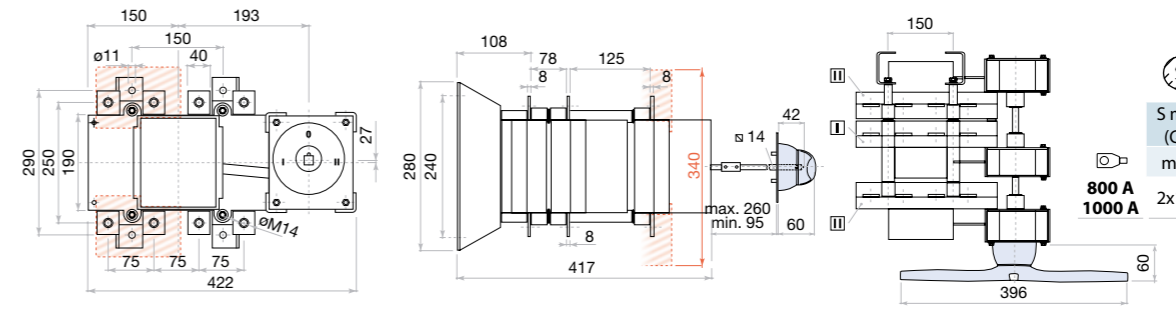

S max (Cu)	H max (Cu)	L max (Cu)	M
mm ²	mm	mm	Nxm
2x185	6	40	M10 24