

S5000M AC Switch - disconnecter base mounting 6P - 8P

Size 3
A 800 | 1000

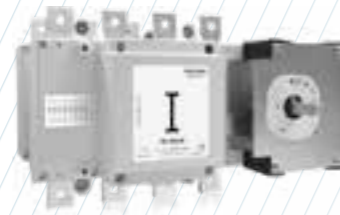

	CODE-800A	CODE-1000A
6P	S5M08006PRO	S5M10006PC0
8P	S5M08008PRO	S5M10008PC0

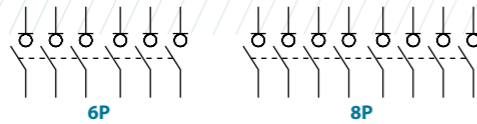

Technical information



According to IEC/EN 60947-3

		800		1000	
Rated thermal current in ambient at RH 60%	Ith	40 °C	A	800	1000
		50 °C	A	800	1000
		60 °C	A	800	900
Rated insulation voltage	Ui	V		1000	1000
Rated dielectric strength	50 Hz., 1 min.	V		8000	8000
Rated impulse withstand voltage	Uimp	kV		12	12
AC rated operational current ⁽¹⁾ (Rated operational frequency 50/60 Hz)	Ie	Ue 400V AC21A	A	800	1000
		Ue 400V AC22A	A	800	1000
		Ue 400V AC23A	A	800	1000
		Ue 500V AC21A	A	800	1000
		Ue 500V AC22A	A	800	1000
	Ue 500V AC23A	A	800	800	
AC rated operational power ⁽²⁾	Pe	3x400V AC23A	kW	443,4	554,2
Rated capacitor power	400V, sen φ = 0,65	kVAr	360,2	450,3	
Rated breaking capacity	400V AC23A	A	6400	8000	
Rated making capacity	400V AC23A	A	8000	10000	

		800		1000	
Short - circuit behaviour					
Rated short-circuit making capacity ⁽³⁾	Icm	kA (peak)	60	60	
Rated short-time withstand current (1sec.)	Icw	kA rms	25	25	
Conditional short - circuit current (rms value) ⁽⁴⁾		kA rms	72	72	
Maximum cut - off current (peak value)		kA (peak)	55	55	
Maximum power dissipation (I ² t)		A ² s (x10 ³)	4900	4900	
Mechanical features					
Minimum number of mechanical operations ⁽⁵⁾	Cycles		10000	10000	
Maximum weight 6P		Kg	18,5	18,5	
Maximum weight 8P		Kg	20	20	

⁽¹⁾ Other voltages and / or utilization categories. Please consult
⁽²⁾ Indicative values: current values vary from one motor manufacturer to another
⁽³⁾ Without limiting protective device (short-circuit maintained 50... 100 ms.)
⁽⁴⁾ With a protective device limiting the cut - off current and the joule integral to the indicated values
⁽⁵⁾ Please consult us for more operations
⁽⁶⁾ Rated operational current AC22B

Accessories



Direct handle
CODE DS-LI41



Panel handle included shaft ^(e1)
IP65 | UL50E/NEMA 250
Types: 1, 3R, 4, 4X y 12
CODE DS-LA41



Panel handle without shaft
IP65 | UL50E/NEMA 250
Types: 1, 3R, 4, 4X y 12
CODE DS-LA43



Emergency panel handle included shaft ^(e1)
IP65 | UL50E/NEMA 250
Types: 1, 3R, 4, 4X y 12
CODE DS-LR41

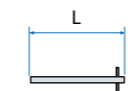

Shafts
Standard shaft included ^(e1)
L (mm) | P (mm)
239 | 408... 573

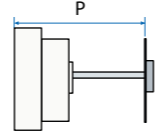

Dimensions (mm)

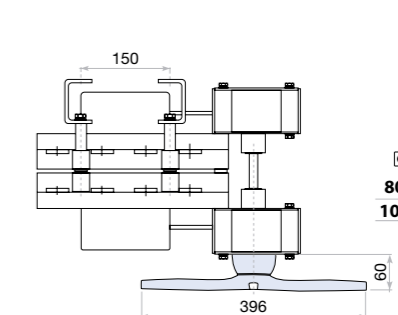
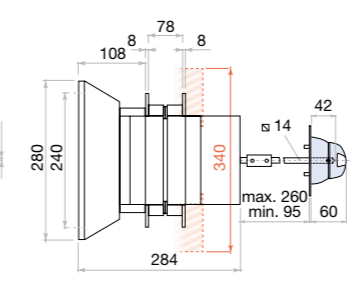
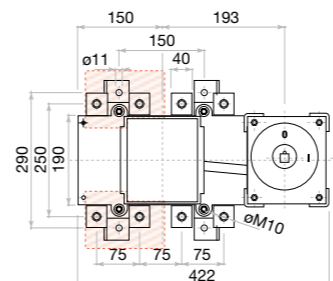

	S max (Cu)	H max (Cu)	L max (Cu)	T	M
	mm ²	mm	mm		Nxm
800 A	2x240	2x5	50	M14	45
1000 A	2x300	2x10			



Terminal shrouds
CODE DS-CU31
(1 kit for input or output only frontal side)



Auxiliary contacts
1NA+1NC CODE DS-AU11
2NA+2NC CODE DS-AU12
Ie = 16 A (resistive loads)
4 A (inductive loads) at 250 Vac.



Safety key lock devices
Simple CODE DS-CB41
Double CODE DS-CF41
For external handle, lock the handle by means of a key in position "OFF" (under request, in "ON"), the key can only be removed with the handle locked

Panel drilling for handle and keylock device
Simple Double

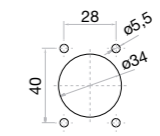
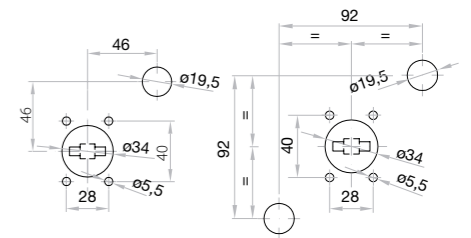

Panel drilling for panel handle

