

PIXSYS
electronics

www.pixsys.net ☎ +39 041 5190518 R.A.

CODE : **2000.90.198**

PTC1K-6x40-A304-0000-6,0GSC

DESCRIPTION :
PTC1K sensor 6x40 mm,
no process connection with 6m silicon cable.

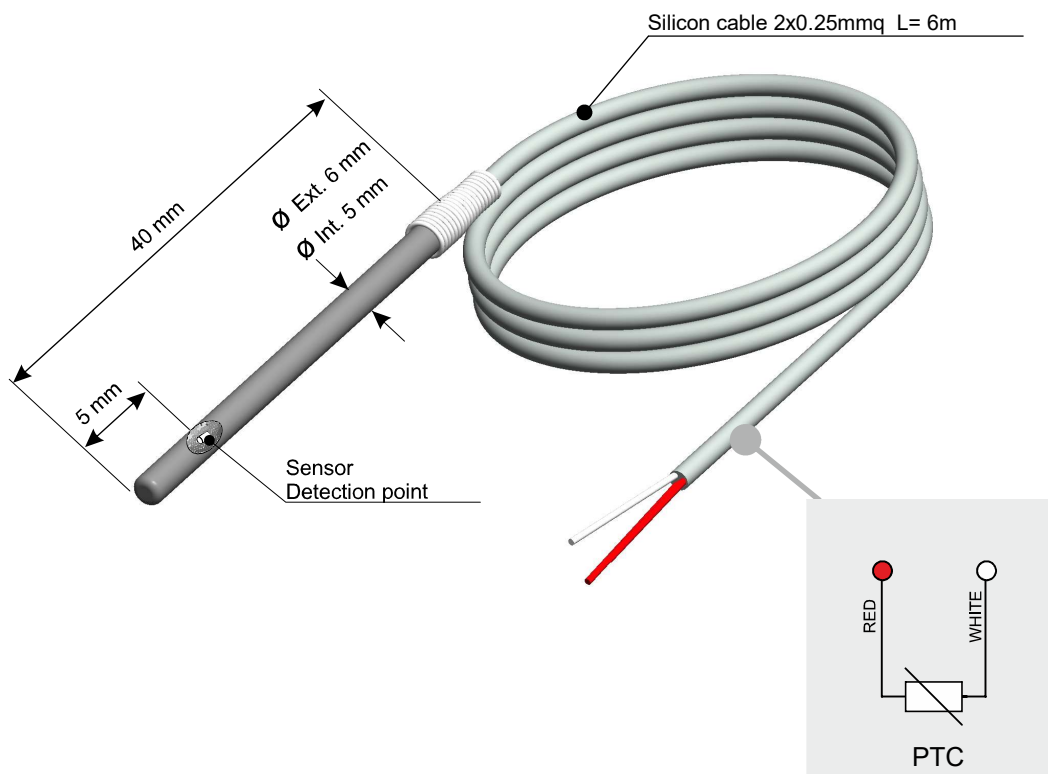

OPERATING TEMPERATURE :	-50°C + 120°C
SENSOR :	PTC KTY 82 - 121 1K 1% SMD
ACCURACY :	1%
RESPONSE TIME :	K (constant)= 10sec. with water flow speed at 2m/s
IMMERSION MATERIAL :	Steel AISI 304
JUNCTION MATERIAL :	Not available
SENSOR INSULATION :	Not available
TAPERING :	NO
CERTIFICATION :	NO
CABLE MATERIAL :	GSC Silicon
PROTECTION :	IP67

CONNECTION CABLE FEATURES					
SHEATH MATERIAL	TEMPERATURE [°C]		ABRASION RESISTANCE	HUMIDITY RESISTANCE	FLAME BEHAVIOUR
	EXERCISE	INSTANTANEOUS			
PVC	-30 / + 105	+ 105	Good	Good	Self-extinguish
GSC Silicon rubber	-40 / + 250	+ 250	Sufficient	Fair	Self-extinguish
TFE Teflon	-200 / + 260	+ 310	Excellent	Excellent	Self-extinguish
KAP Kapton	-200 / + 400	+ 440	Fair	Good	Self-extinguish
TTS Glass fiber	-200 / + 500	+ 500	Poor	Poor	incombustible
TTC Ceramic fiber	+ 1000	+ 1100	Poor	Poor	incombustible

EASYUP CONFIGURATION

To simplify installation start-up, "EasyUp" mode allows to select type of sensor and to fix its measuring range on the controller by entering a password (see table below).

EASYUP CODE FOR THIS SENSOR :

2202

SENSOR SELECTION :	PTC
LOWER LIMIT :	-50°C
UPPER LIMIT :	+120°C

ATR142 CONNECTION

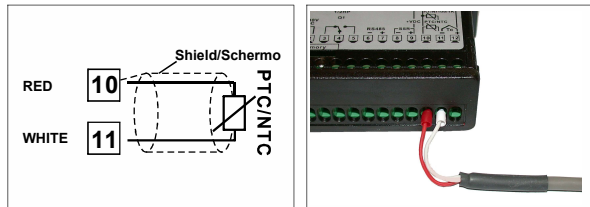

N.B. EasyUp on software version 1.12 or greater

ATR401 CONNECTION

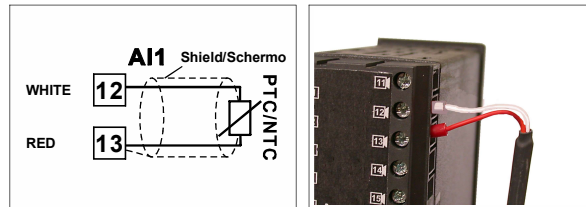

N.B. EasyUp on software version 1.01 or greater

ATR236 /243 CONNECTION

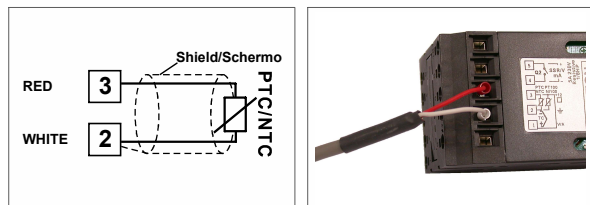

N.B. EasyUp on software version 1.18 or greater

DDR245 CONNECTION

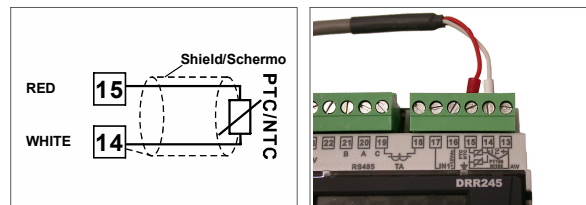

N.B. EasyUp software version 1.18 or greater

ATR621 / 171 CONNECTION

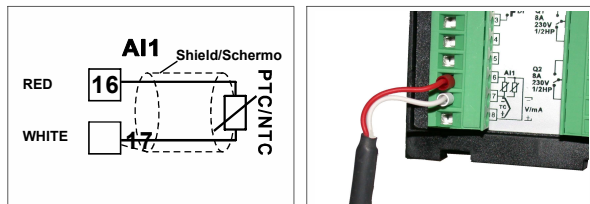

N.B. EasyUp on software version 1.01 or greater

SLIDING JUNCTION

SLIDING JUNCTION :
(optional)

Code : 2000.30.003 1/8" GAS at Ø 6 mm

Code : 2000.30.006 1/4" GAS at Ø 6 mm

Code : 2000.30.009 1/2" GAS at Ø 6 mm

MATERIAL : STEEL AISI 316L

