

COPPER TUBE CRIMPING LUGS ANGLED 90°

for Copper conductors

A-L

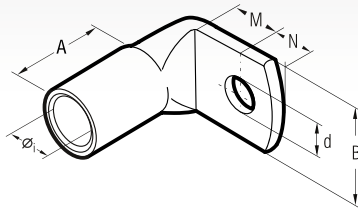

Conductor Size sqmm		Type	Dimensions mm							Quantity Box/Bag	Mechanical Tools		Hydraulic Tools	
Low Str.	Flex*		Øi	B	M	N	A	d						
6	6	A1-L6*	3,6	11,0	7,0	6,0	9,5	6,4	2.000/100	HN1	HN-A25	B15MD	HT45-E B450ND-BV	
	5	A2-L5	4,6	10,0	6,5	6,0	10,5	5,3	1.500/100					
10	6	A2-L6	4,6	11,0	7,0	6,0	10,5	6,4	1.500/100	HN5	HN-A25	B15MD	HT45-E B450ND-BV	
	8	A2-L8	4,6	15,0	9,0	8,0	10,5	8,4	500/100					
16	5	A3-L5	5,8	11,5	6,5	6,0	11,5	5,3	1.000/100	HN5	HN-A25	B15MD	HT45-E B450ND-BV	
	6	A3-L6	5,8	11,5	7,0	6,0	11,5	6,4	1.000/100					
	8	A3-L8	5,8	15,0	9,0	8,0	11,5	8,4	1.000/100					
25	10	A3-L10	5,8	18,0	11,0	10,0	11,5	10,5	500/100	HN5	HN-A25	B15MD	HT45-E B450ND-BV	
	6	A5-L6	7,0	14,0	7,0	6,0	13,0	6,4	500/100					
	8	A5-L8	7,0	15,0	9,0	8,0	13,0	8,4	500/100					
35	10	A5-L10	7,0	18,0	11,0	10,0	13,0	10,5	500/100	TN70SE	TN120SE**	B15MD	HT45-E B450ND-BV	
	6	A7-L6	8,9	17,0	7,0	6,0	15,5	6,4	500/100					
	8	A7-L8	8,9	17,0	9,0	8,0	15,5	8,4	300/100					
50	10	A7-L10	8,9	19,0	11,0	10,0	15,5	10,5	400/100	TN70SE	TN120SE**	B15MD	HT45-E B450ND-BV	
	12	A7-L12	8,9	21,0	14,0	12,0	15,5	13,2	300/100					
	6	A10-L6	10,0	19,0	8,0	7,0	16,5	6,4	300/100					
70	8	A10-L8	10,0	19,0	9,0	8,0	16,5	8,4	300/100	TN70SE	TN120SE**	B15MD	HT45-E B450ND-BV	
	10	A10-L10	10,0	20,0	11,5	9,5	16,5	10,5	200/50					
	12	A10-L12	10,0	21,0	12,0	12,0	16,5	13,2	200/50					
95	8	A14-L8	11,3	21,0	9,0	8,0	20,0	8,4	200/50	TN70SE	TN120SE**	B15MD	HT45-E B450ND-BV	
	10	A14-L10	11,3	21,0	11,0	10,0	20,0	10,5	200/50					
	12	A14-L12	11,3	22,0	14,0	12,0	20,0	13,2	150/50					
120	16	A14-L16	11,3	26,0	18,0	16,0	20,0	17,0	150/50	TN70SE	TN120SE**	B15MD	HT45-E B450ND-BV	
	8	A19-L8	13,5	25,0	9,0	8,0	24,5	8,4	100/25					
	10	A19-L10	13,5	25,0	11,0	10,0	24,5	10,5	100/25					
150	12	A19-L12	13,5	25,0	14,0	12,0	24,5	13,2	100/25	TN70SE	TN120SE**	B15MD	HT45-E B450ND-BV	
	10	A24-L10	15,2	28,5	11,0	10,0	25,5	10,5	50/25					
	12	A24-L12	15,2	28,5	14,0	12,0	25,5	13,2	50/25					
185	10	A30-L10	16,7	31,5	13,0	11,0	28,5	10,5	50/25	TN70SE	TN120SE**	B15MD	HT45-E B450ND-BV	
	12	A30-L12	16,7	31,5	16,0	14,0	28,5	13,2	50/25					
	10	A37-L10	19,2	31,5	13,0	11,0	31,5	10,5	50/25					
240	12	A37-L12	19,2	31,5	16,0	14,0	31,5	13,2	50/25	TN70SE	TN120SE**	B15MD	HT45-E B450ND-BV	
	10	A48-L10	21,1	39,0	13,0	11,0	33,0	10,5	30/15					
	12	A48-L12	21,1	39,0	16,0	14,0	33,0	13,2	30/15					
300	240	A60-L12	23,7	44,0	20,0	14,0	42,0	13,2	20/10	TN70SE	TN120SE**	B15MD	HT45-E B450ND-BV	
	300													

*Actual conductor section may require a larger lug eg for 120mm² size use A30-... lug.

**See page 127

A-L series lugs angled 90° are manufactured from electrolytic Copper tube.

The dimensions of the tube are designed to obtain the most efficient electrical conductivity and mechanical strength to resist vibration and pull out.

Cembre lugs are annealed to guarantee optimum ductility which is an absolute necessity for connectors which will have to withstand the severe deformation arising when compressed and any bending of the palm during installation.

In applications subject to vibration, terminals still have to perform a reliable connection, annealing plays a vital role in avoiding cracking or breaks between the barrel and palm.

The presence of an inspection hole facilitates full insertion of the conductor, whilst the barrel length has been designed to allow easy and accurate positioning of the dies during the crimping operation.

Lugs are electrolytically Tin plated to avoid oxidation.

Details of the appropriate crimping tools and dies are shown on pages 230 to 231.

*Not UL approved