

Palazzoli

General
Catalogue



2019/2020

Palazzoli



CHIAREZZA DELLA FUNZIONE
SEMPLICITÀ DI PROGETTO
QUALITÀ DELLA MANIFATTURA

CLARITY OF FUNCTION
PROJECT SIMPLICITY
QUALITY OF MANUFACTURE





ALUMAX series low voltage switched sockets with electrical interlock are a range of products in 15/10 steel sheet, finished with hot polymerised nontoxic polyester paint, equipped with an aluminium alloy socket for heavy-duty applications, from 250A up to 400A, with IP65 protection rating.

The coupling system of receptacles and plugs makes use of the Easy Contact technology for maximum contact performance over time and ensures easier connection and disconnection operations. Each connection is provided with a double pilot contact. The sockets are equipped with MCB with 36 kA breaking capacity. The control handle can be padlocked in position 0 and I.

Compliance with standards	IEC/EN 60309-1 IEC/EN 60947-3
Material	Aluminium Alloy (connections) Steel (boxes)
Surface treatment	Passivation
Paint	Non-toxic hot polymerised
Protection rating (IP according to IEC/EN 60529)	IP67 (connections) IP65 (protected wall-mounted sockets)
Colour	RAL 5015 (cover) RAL 7035 (box)
Impact resistance (IK grade according to IEC/EN 62262)	IK10
Rated current	250A - 400A
Operating voltage	Up to 1000V
Operating frequency	50-60Hz
Insulation voltage	3.3 KV
Insulation class	I
Diameter of cable entry for mobile connections	62mm (250A) 80mm (320A-400A)
Clamping range for receptacles and pins	250A: 50mm² - 70mm² 320A: 120mm² 400A: 150mm²
Pilot contacts	2
Pilot contacts clamping section	2.5mm²
Operating temperature	-30°C - +60°C

ALUMAX BROCHURE

The Alumas brochure can be viewed and downloaded from www.palazzoli.com

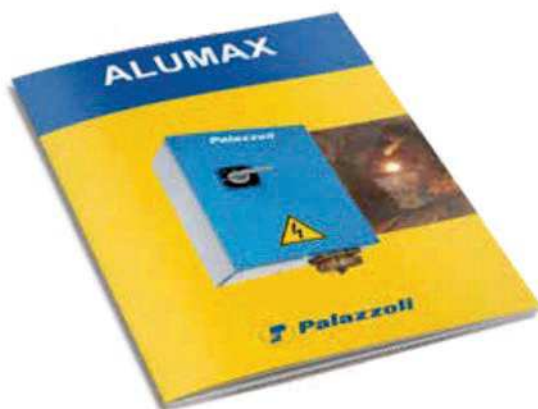

Resistance to chemical agents

WATER	SALINE SOLUTION	ACIDS		BASES		SOLVENTS			
		CONCENTRATED	DILUTED	CONCENTRATED	DILUTED	ALCOHOL	ACETONE	PERCHLORO-ETHYLENE	BENZENE
↑	↑	↓	→	→	↑	↑	↑	↑	↑
OILS		FATS		AMMONIA	OXIDISERS	INORGANIC SALTS	GASOLINE	DETERGENTS	U.V. RAYS
MINERAL	VEGETABLE	ANIMAL	SYNTHETIC						
↑	↑	↑	↑	↑	→	↑	↑	↑	↑

Legend: ↑ high resistance → partial resistance ↓ low resistance



250A sockets in steel for high amperages with **electric interlock** and **MCCB** for wall-mounting 50-60Hz **IP65**

Rated current (A)	Rated voltage (V)	Poles	No. of pilot contacts (mm ²)	Palazzoli code	Pack Qty
250	400	3P+ \neq	2x10	480530	1
		3P+N+ \neq	2x6	480550	1
	500	3P+ \neq	2x10	480531	1
		3P+N+ \neq	2x6	480551	1

Features: padlockable handle.



320A - 400A sockets in steel for high amperages with **electric interlock** and **MCCB** for wall-mounting 50-60Hz **IP65**

Rated current (A)	Rated voltage (V)	Poles	No. of pilot contacts (mm ²)	Palazzoli code	Pack Qty
320	400	3P+N+ \neq	2x6	480650	1
	500	3P+N+ \neq	2x6	480651	1
400	400	3P+N+ \neq	2x6	480750	1
	500	3P+N+ \neq	2x6	480751	1

Features: padlockable handle.



Straight mobile plugs in aluminium alloy for high amperages 50-60Hz **IP67**

Rated current (A)	Poles	No. of pilot contacts (mm ²)	Palazzoli code	Pack Qty
250	3P+ \neq	2x10	750530	1
	3P+N+ \neq	2x6	750550	1
320	3P+N+ \neq	2x6	750650	1
	400	3P+N+ \neq	2x6	750750

Note: up to 660A available on request.

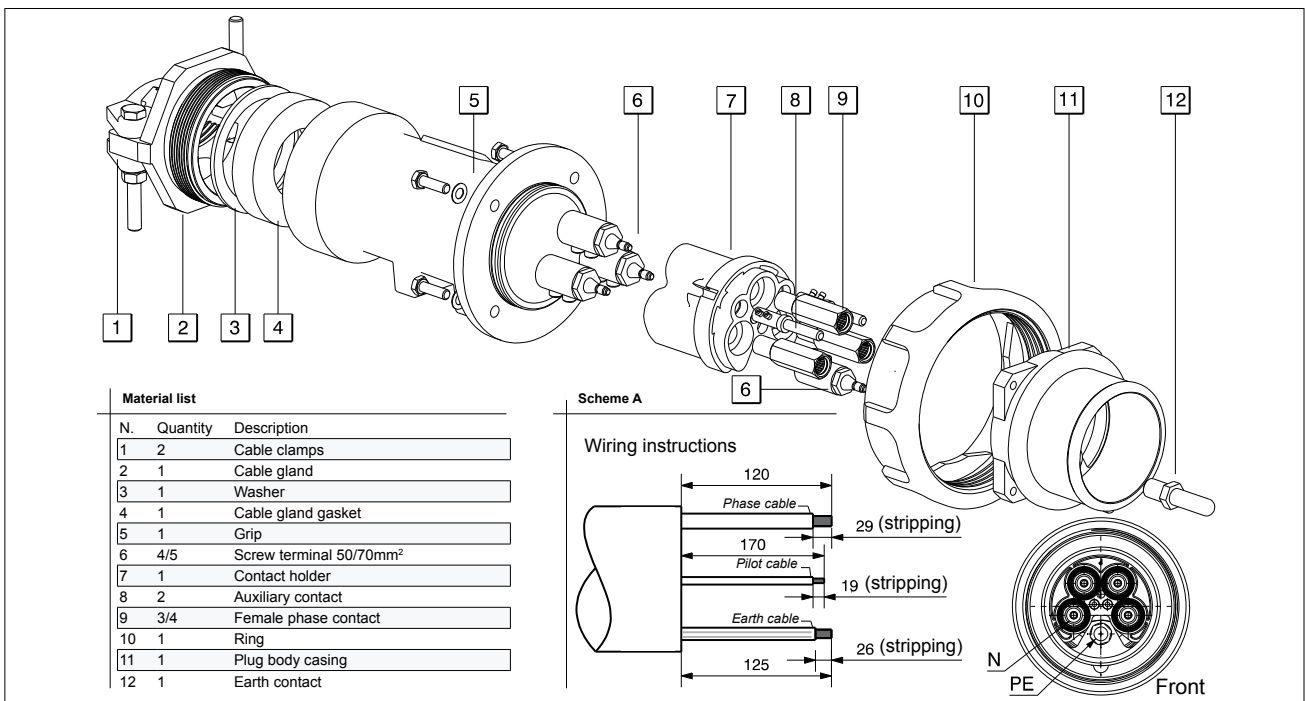

The background of the entire page is a night-time satellite view of the Earth, showing the illuminated landmasses of Europe and Africa. A bright sun or star is positioned at the horizon, creating a lens flare effect. Overlaid on this image is a network of glowing blue lines connecting various points, resembling a global communication or data network. The Palazzoli logo is prominently displayed at the top center.

Palazzoli

— excellence —
FROM ITALY

Palazzoli S.p.A
25128 Brescia - Italy - Via F. Palazzoli, 31
Tel +39 030 2015.1
Fax +39 030 2015.258
www.palazzoli.com
export@palazzoli.com
