



design: ufficio tecnico Stral / Stral technical department

FLYBACK114LED

Corpo

Corpo in acciaio inox AISI 316L di diametro 114mm disponibile nella versione satinata ed elettro-lucidata. Viti in acciaio inox A4. Flangia di fissaggio in acciaio inox AISI 316L. Diffusore in policarbonato opale o trasparente. Disponibile nelle altezze: 500mm, 750mm e 1150mm. Verniciatura del corpo disponibile in vari colori a richiesta.

Sorgenti

LED multi-chip da 10W. Temperatura colore da 3000K e 4000K.

Emissioni

Diffusore in policarbonato opale diffondente o trasparente.

Alimentazione

Alimentatore elettronico integrato. 220-240 Vac 50/60 Hz. Classe di isolamento II. Classe energetica A/A+/A++ Regolamento EU 874/2012. Questi dispositivi sono muniti di sorgente a LED integrata. Le sorgenti di questo dispositivo non sono sostituibili.

Installazione

Apparecchio per installazione a terra tramite tassello, oppure, come accessorio, tirafondi in acciaio inox A2 da cementare.

Body

Body in AISI 316 stainless steel with a diameter of 114mm available in satin and electro-polished version. Screws in A4 stainless steel. Fixing anchor bolts in AISI 316L stainless steel. Diffuser in opal or transparent polycarbonate. Available in the followings heights: 500mm, 750mm and 1150mm. Painting process of the body in different colors is available on demand.

Sources

Multi-chip LED with a power of 10W. Available with 3000K, 4000K CCT.

Emissions

Diffuser in opal or transparent polycarbonate.

Supply

Integrated electronic power supply. 220-240 Vac 50/60 Hz. Class of insulation II. Energy class: A/A+/A++. EU Regulation 874/2012. These devices are equipped with integrated LED modules, The light sources of these devices are not replaceable.

Installation

Luminaire for floor installation through fishers, or, as accessory, anchor bolts in A2 stainless steel to cement.

FLYBACK114LED

versione H 500 / H 500 version

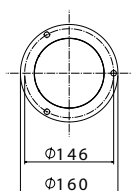
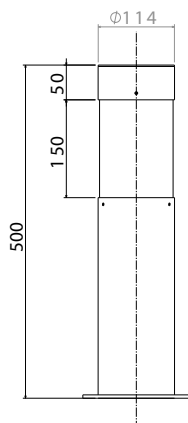

IK08

IP65



LED A A+ A++

Alimentatore elettronico incluso
Electronic driver included

Vetro trasparente/transparent glass

464.0001 LED 10W bianco/white 3000K

464.0002 LED 10W bianco/white 4000K

Vetro satinato/satin glass

464.0004 LED 10W bianco/white 3000K

464.0005 LED 10W bianco/white 4000K

61002 Flangia di fissaggio con 3 tirafondi/Fixing flange with three anchor bolts

FLANGIA / FLANGE PAG. 288

versione H 750 / H 750 version

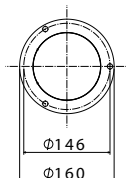
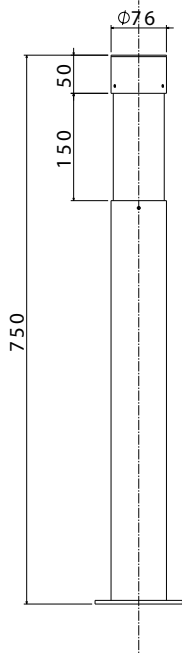

IK08

IP65



LED A A+ A++

Alimentatore elettronico incluso
Electronic driver included

Vetro trasparente/transparent glass

464.0101 LED 10W bianco/white 3000K

464.0102 LED 10W bianco/white 4000K

Vetro satinato/satin glass

464.0104 LED 10W bianco/white 3000K

464.0105 LED 10W bianco/white 4000K

61002 Flangia di fissaggio con 3 tirafondi/Fixing flange with three anchor bolts

FLANGIA / FLANGE PAG. 288

FLYBACK114LED

versione H 1150 / H 1150 version

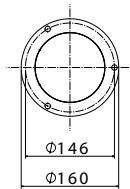
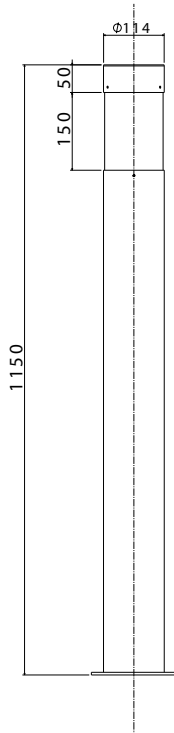

IK08

IP65



LED A A+ A++

Alimentatore elettronico incluso
Electronic driver included

Vetro trasparente/transparent glass

464.0201 LED 10W bianco/white 3000K

464.0202 LED 10W bianco/white 4000K

Vetro satinato/satin glass

464.0204 LED 10W bianco/white 3000K

464.0205 LED 10W bianco/white 4000K

61002 Flangia di fissaggio con 3 tirafondi/Fixing flange with three anchor bolts

FLANGIA / FLANGE PAG. 288

