

# MECHANICAL LUGS

# MLA-C

For Low and Medium voltage Al/Cu conductors

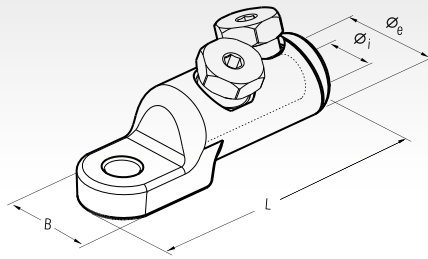

Conductor Size sqmm	Type	Ø Stud mm	Dimensions mm				N° of Bolts	Number of centring devices	Quantity Box/Bag
			Øe	Øi	B	L			
50-240	MLA50-240-12C	12	33	20,5	33	106,5*	2	3 ● ● ●	1/10

\*without centring devices



Cembre range-taking mechanical connectors are intended for use with Copper and Aluminium conductors, for low and medium voltage (up to 52kV) installations, in indoor, outdoor and underground applications. Mechanical connector bodies (pic.1) are made from Aluminium EN-AW 2011 T6 with cross sectional area and barrel length designed to optimise

electrical connectivity. Internal surfaces are protected against oxidation by grease with a very high dropping point, while the Tin plating on external surfaces has a minimum thickness of 12 µm for improved surface protection. Shear bolts (pic.2) are made from the same material and designed to ensure a reliable electrical connection

simply by tightening the bolts with a standard socket until shearing occurs inside the threaded hole without external protrusion. To minimise voltage stresses, connectors are provided with centring devices (pic.3) to improve the alignment of the different conductor sizes.

### Key features:

- Wide range of conductor cross sections
- Suitable for Copper and Aluminium conductors
- Tested according to IEC 61238
- Torque controlled to guarantee a good electrical contact
- Reduces inventory levels
- Easy installation - only requires a standard socket
- Reduced installation time

Pic. 1



Conductor Size sqmm	Centring device	
	Color	Type
50 - 70 - 95	Red	
120 - 150	Blue	
185	Yellow	
240	Not required	

Pic. 3